

NOTES:

- CONTRACTOR TO FIELD MEASURE DIMENSIONS OF NEW GATES AND FENCING. CONFIRM EXTENT OF FENCING WITH OWNER'S REPRESENTATIVE PRIOR TO PURCHASE AND INSTALLATION.
- EXCESS SOIL SHALL BE REDISTRIBUTED THROUGHOUT THE ROCK SLOPES. TAMP AND WATER SOIL DOWN INTO THE DEPTHS OF THE ROCK SLOPE IN SEVERAL LIFTS.
- USE DISPLACED ROCKS FOR TREE PLANTING ON SLOPE, SEE DETAIL 3, SHEET L4.2. EXCESS ROCKS SHALL BE RELOCATED TO EAST FACING SLOPE AT EAST AREA OF PROPERTY. CONFIRM PLACEMENT WITH OWNER'S REPRESENTATIVE PRIOR TO RELOCATION. CONTRACTOR MAY OFF-HAUL EXCESS ROCKS AT CONTRACTOR'S DISCRETION AND OWNER'S APPROVAL.
- PLANTING ALONG ROCK SLOPE SHOWN IN PLAN IS APPROXIMATE AND MAY VARY DUE TO EXISTING CONDITIONS. CONTRACTOR TO COORDINATE WITH LANDSCAPE ARCHITECT TO ASSIST AND APPROVE FINAL PLANT PLACEMENT PRIOR TO INSTALLATION.
- ALL EXPOSED SLOPES 3:1 OR GREATER SHALL RECEIVE EROSION CONTROL BLANKET, INSTALL PER MANUFACTURER'S SPECIFICATIONS, REFER TO SECTION 32 43 00

KEEP NEW TREES 30' FROM EAST FENCE LINE, AS CLOSE TO THE NORTHERN FENCE AS POSSIBLE, CONFIRM WITH LANDSCAPE ARCHITECT PRIOR TO INSTALLATION.

NORTH-WEST ENTRANCE - ENLARGEMENT  
3  
L4.1

PLANTING AT ROCK SLOPE  
4  
L4.2

- 15 AES GAL CALIFORNIA BUCKEYE
- 2334 9F FES GAL CALIFORNIA FESCUE PLUGS 12" O.C.
- 10 GAR ELL COAST SILKTASSEL
- 63 FRE CAL FLANNEL BUSH
- 93 ARC PAC PACIFIC MIST MANZANITA

STEEL SECURITY FENCE ALONG PROPERTY FRONTAGE, SEE NOTE 1, REFER TO 4 L4.1

TREE PLANTING ON SLOPE 3 L4.2

GATE AT STAIRS - ENLARGEMENT 2 L4.1

13 QUE AGR COAST LIVE OAK

102 ROM COU MATILAJA POPPY

96 QUE BER CALIFORNIA SCRUB OAK

290 CAL NUT PACIFIC REED GRASS

349 SAL CLE SALVIA CLEVELANDII

360 ASC SPE SHOWY MILKWEED

VEHICULAR ENTRANCE - ENLARGEMENT 1 L4.1

47 LYO FLO SANTA CRUZ ISLAND IRONWOOD

132 HET ARB TOYON  
15 GAL  
110 CEA CON CALIFORNIA MOUNTAIN LILAC  
5 GAL

163 ERI GRA RED BUCKWHEAT  
1 GAL  
141 SYM ALB SNOWBERRY  
1 GAL

29 MYR CAL PACIFIC WAX MYRTLE  
5 GAL  
14 RHU OVA SUGAR BUSH  
5 GAL

121 MIM AUR STICKY MONKEY FLOWER  
1 GAL  
85 LON INV TWINBERRY  
5 GAL

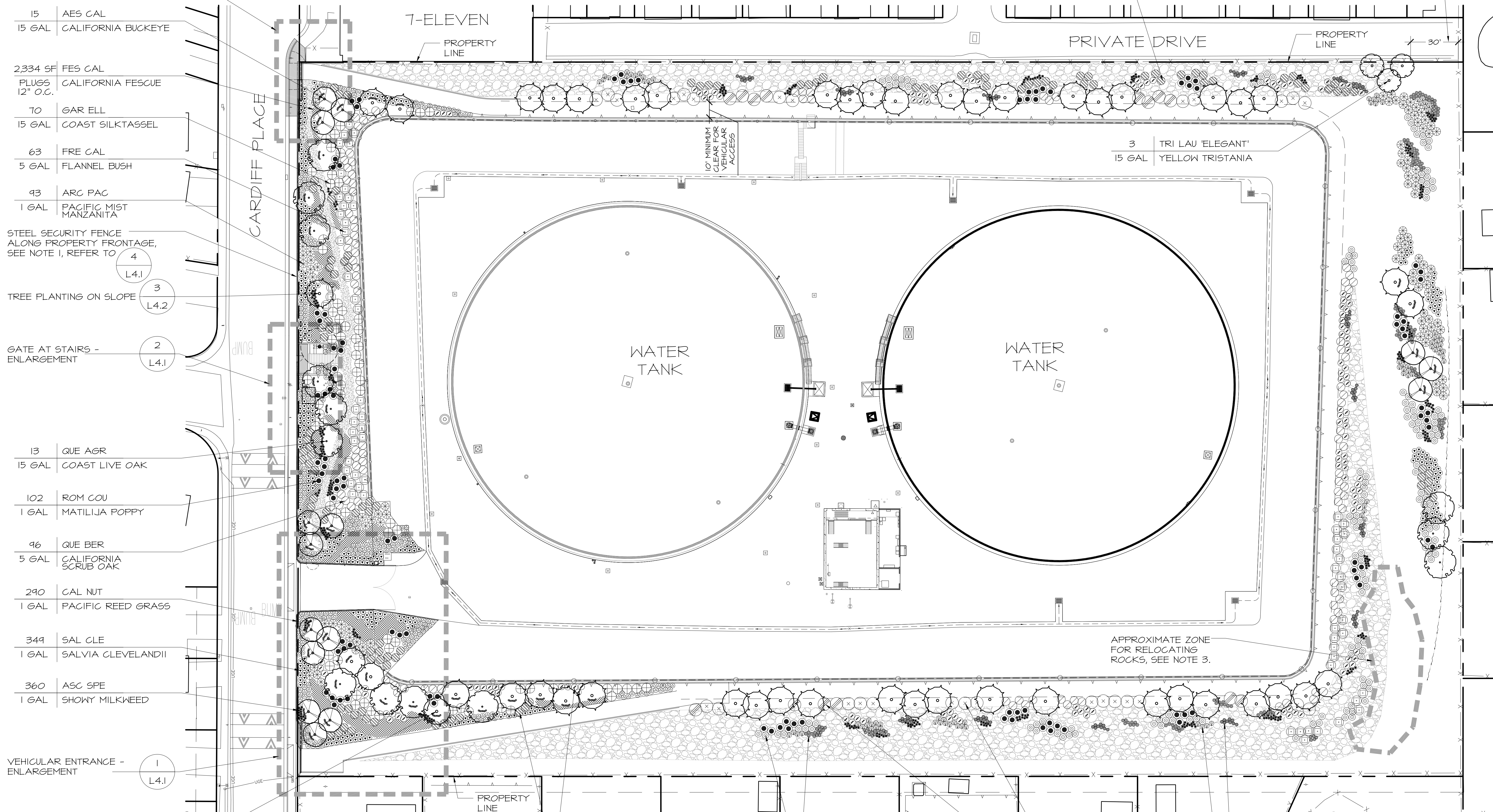
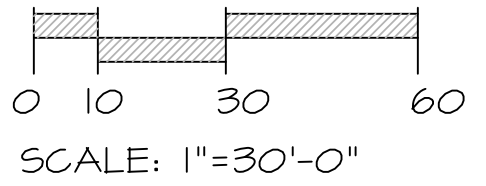

NO.	DATE	DESCRIPTION
1		
2		
3		
4		
5		

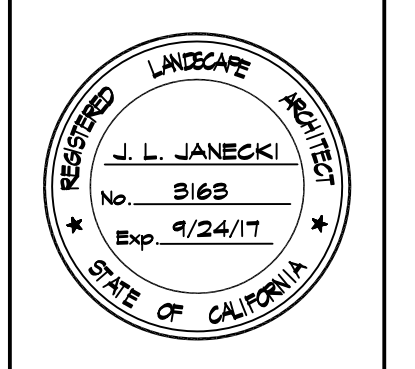

**JONI L. JANECKI & ASSOCIATES**  
515 SWIFT ST. SANTA CRUZ, CA 95060  
PHONE 831.423.6040 | FAX 831.423.6094  
EMAIL JL@JLJA.COM | WWW.JLJA.COM  
California Landscape Architect License #163

Project: **CITY OF SANTA CRUZ WATER DEPARTMENT  
BAY RESERVOIR TANK  
SITE LANDSCAPING**  
200 CARDIFF PLACE SANTA CRUZ, CA

Sheet Title: **LANDSCAPE PLAN**

Job No. 07-100  
Scale: ED  
Drawn By: ED  
Issued: APRIL 26, 2017

L4.0