

Street/Road Closure Information for Special Events Permits Issued in the City of Santa Cruz

Street/road closure requests for special events, parades, and block parties are reviewed by the City of Santa Cruz, and, as appropriate, a permit is issued to an “Event Coordinator,” the party responsible for the event. Fees are often required. A street/road closure does not include sidewalk areas; sidewalks must remain open and accessible to businesses and community members.

It is the responsibility of the Event Coordinator to ensure that:

- ⇒ The current standards as stated in the Manual for Uniform Traffic Control Devices (MUTCD) for temporary street/road closure(s), with appropriate signage and barricades, are followed. (<http://mutcd.fhwa.dot.gov>)
- ⇒ Businesses and/or neighbors affected by the street/road closure(s) are notified.
- ⇒ All closure locations are monitored by a qualified adult (details below).
- ⇒ The devices have reflective material or are equipped with lighting for maximum visibility.

Because each closure location is unique, some may require professional design and installation. The information provided here regarding signage and type of barricades is offered as a guide only. The MUTCD standards must be met in all circumstances.

In order to ensure participant safety, the MUTCD standards must be in place to block streets/roads from traffic. Standard requirements from the MUTCD for proper street/road closure monitoring include combinations of patterns using the following devices:

- ⇒ Standard Barricades (Type I, Type II, and Type III)
- ⇒ Orange Cones (28" in height)
- ⇒ Proper Signage

Emergency access into the area shall be maintained at all times by providing a 16' access lane. A qualified adult shall be responsible for removal of barricades and providing a path in the case of an emergency. NOTE: Intersections that have a fire hydrant located on a corner shall have the devices adjusted in order to allow access to the hydrant by Fire Department trucks and personnel.

- **Standard Barricades (Type I, Type II, and/or Type III Barricades) (Approximately 4–8 per street are required in conjunction with cones.)**

Barricades shall be:

- ⇒ A portable or fixed device, with one, two, or three appropriately marked rails.
- ⇒ The primary device used to close, restrict, or delineate all or a portion of a right-of-way.
- ⇒ Placed so that there is no gap large enough for a vehicle to pass through. Residential block parties in low-traffic areas may use at least four (4) of the Type 1 or II Barricades with cones.
- ⇒ A minimum of 24" in width and 36" in height for Type 1 and Type II Barricades.
- ⇒ A minimum of 48" in width and 60" in height for a Type III Barricade.
- ⇒ Lighted during hours of darkness.
- ⇒ Posted with signs that indicate the date(s) as well as the beginning and ending time(s) of the street/road closure.

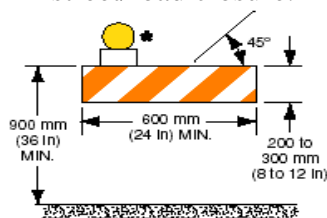

Type I Barricade

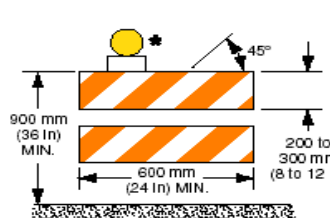

Type II Barricade

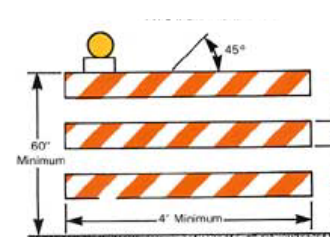

Type III Barricade

Note: Longitudinal Barricades are **not** approved for street closures, but may be used to set boundary areas for people.



- Orange Cones (*Approximately 6–12 per street are required and are to be used in conjunction with barricades.*)

Cones shall be:

- ⇒ Secondary and complementary devices to barricades for street/road closures.
- ⇒ Predominantly orange with a wide white band located 3" to 4" from the top of the cone with an additional 4"-wide white band located approximately 2" below the 6" band.
- ⇒ Made of a material that can be struck without causing damage to an impacting vehicle.
- ⇒ Not less than 28" in height and have reflective material or be equipped with lighting for maximum visibility.

- Proper Signage (*used in conjunction with barricades and cones*)

Signs shall be:

- ⇒ Used to inform drivers of a street/road closure ahead, "Road Closed."
- ⇒ Placed out of the pedestrian right-of-way, but be visible to drivers.
- ⇒ 24" x 24" in size.
- ⇒ Printed with the date(s) as well as the beginning and ending time(s) of the street/road closure.
- ⇒ Affixed to a barricade that does not block the sidewalk.

EXAMPLE:

<p>ROAD CLOSED TIME: _____ DATE: _____</p>

NOTE: Barricades/cones are available for rent at StopCo (831-238-1066), Traffic Safety & Signs (408-993-9770), A Tool Shed (831-477-7133), Western Traffic Supply (925-249-1854, or other traffic equipment rental companies.

- Adult Monitors (*One (1) monitor per barricade location is required.*)

Conditions of Use for special event permits issued by the City of Santa Cruz will always require that street/road closures be monitored at all times.

Adult Monitors shall be:

- ⇒ Eighteen (18) years of age or older.
- ⇒ Capable of moving the barricades to allow access only for emergency vehicles.
- ⇒ Clothed in identifiable clothing.
- ⇒ Equipped with a flashlight and clothed in a reflective vest during times of limited light.
- ⇒ Required to read the information sheet entitled "Barricade Monitoring and/or Street Closures Information for Monitors."

If you have any questions, please call the City of Santa Cruz Special Events Office at (831) 420-5132 or email kagnone@cityofsantacruz.com .

Barricade Requirements w-drawing Sept 2017

Example of a street closure

(not to scale)

MUTCD standards must be followed.

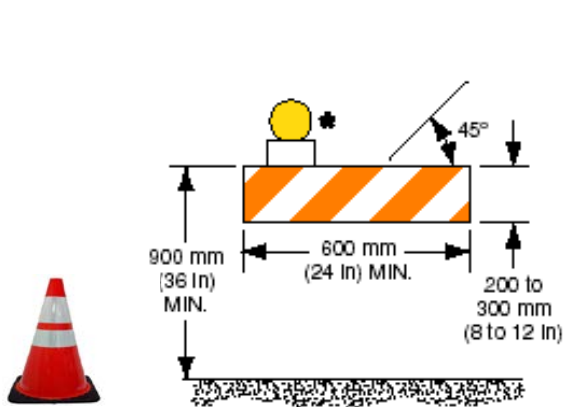

16 ft emergency clearance w/adult monitor



CURB

Type I or Type II barricade

Type III barricade

28" cones

CURB

Example of simple low traffic Block Party street closure (not to scale)

MUTCD standards must be followed.

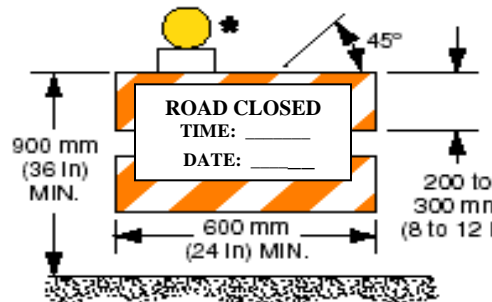
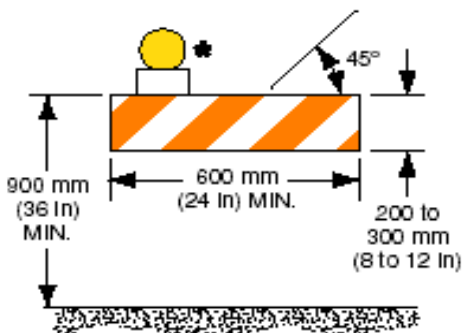

16 ft emergency clearance w/adult monitor



CURB

Type I or Type II barricade

Type I or Type II barricade

28" cones

CURB